

OakView Personal Care at Springhill

OakView provides added support for living a pleasurable, engaged life, while giving families peace of mind.

The Bayberry

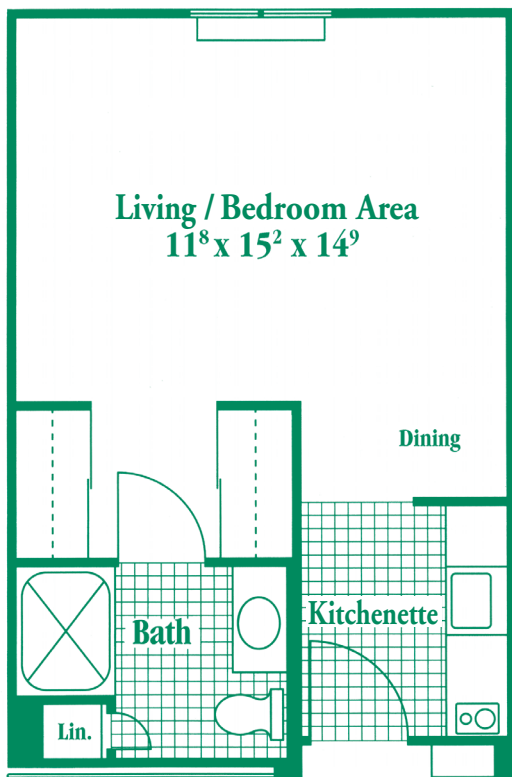

The Chestnut

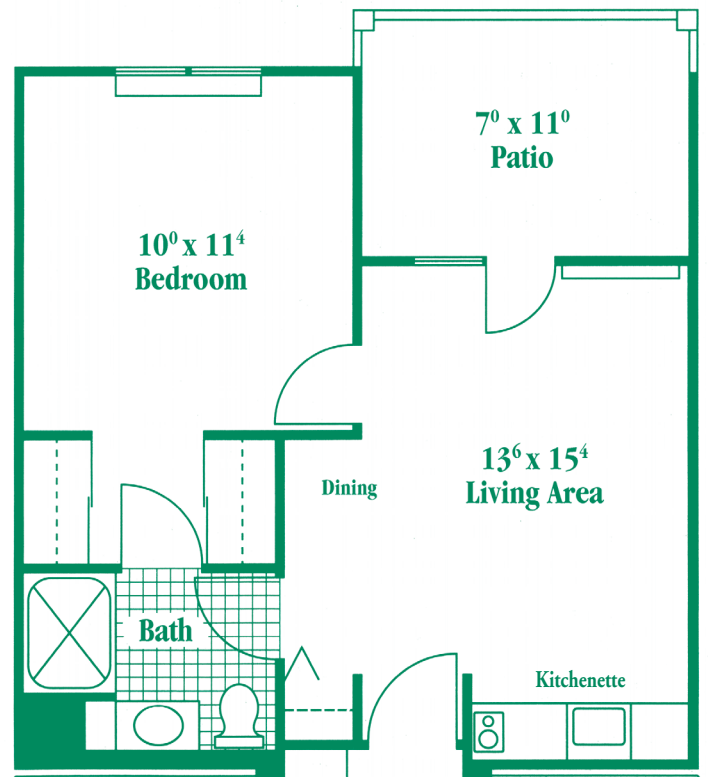

Room sizes and details subject to some variation.

OakView Personal Care at Springhill

Apartment Home Features

- Wall-to-wall carpet
- Kitchenette
- Patio or balcony in some locations
- Individually controlled heating and air conditioning
- Sprinkler and smoke detection system
- Full bath with walk-in shower

Included Services

- Complete Dining Plan
- Daily housekeeping
- Weekly laundry
- All interior and exterior maintenance
- All utilities except telephone, cable TV, and internet
- Scheduled transportation
- Assistance in bathing, dressing, and grooming
- Supervision and administration of medication
- Individual and group activities
- Social services support
- Full health care staff and nursing services
- Emergency response system
- 24-hour security
- Priority access to skilled nursing and/or memory support neighborhood

Community Amenities

- 45 wooded acres with walking paths
- Outdoor gardens and greenhouse
- Full service restaurant
- Casual café and outdoor dining patio
- Private dining room
- Community room for meetings, performances, and lectures
- Library
- Fitness center with Nautilus™ equipment
- Billiard and game rooms
- Computer lab
- Salon
- Guest suites for visitors

Available Services

- On-site physician
- Choice Plus companion/personal care attendant

Springhill

 An Asbury Community



2323 Edinboro Road, Erie, PA 16509-3492 (814) 860-7042 or (800) 755-6784
www.SpringhillErie.org

